

## Do you want get more it?

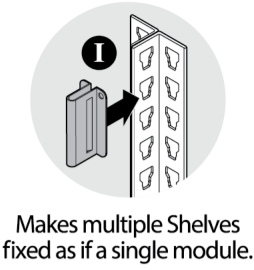
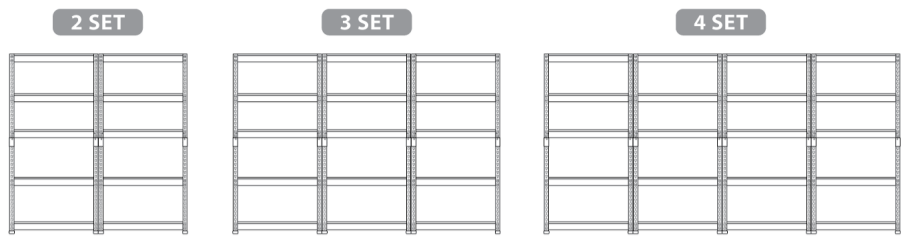

Makes multiple Shelves fixed as if a single module.

## MULTIPURPOSE & TRANSFORMATION

whatever you imagine, it is possible.

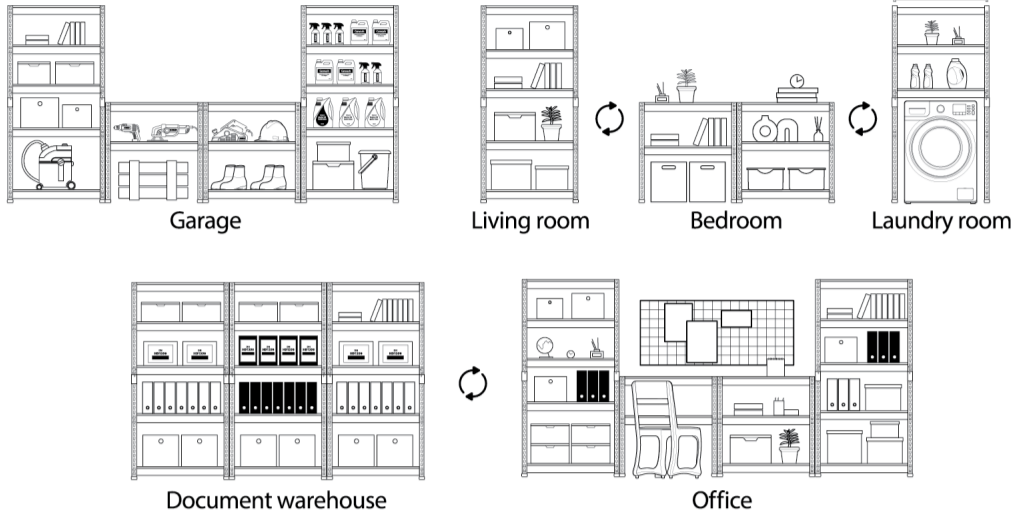

## SAFETY PRECAUTIONS

### ASSEMBLY

- After opening the package, please check whether there are no problems with the components.
- Assemble and use the product on a flat surface and in a safe place.
- Do not install more than four posts when extending a height.
- When using an iron hammer, lay down a cotton towel and hit.

### USE

- Check whether the product has been well assembled before use.
- Do not climb or hang on the product.
- Be careful of the protrusion or edges that may cause injury.
- It is possible to turn into diverse modules nevertheless please refrain from any unstable structural changes, (unbalanced assembly, removing parts arbitrarily, etc.)
- Do not load the product be vibrated.
- If there are dirty substances or liquids on it, wipe it with a dry towel and dry it completely.

### STORAGE

- Do not install the product in high temperatures, near chemicals, and fire sources.
- Keep the product in a dry and well-ventilated place.
- Please be careful that if the product is left in a humid place for a long time, it may bend.

## RECOMMENDATIONS

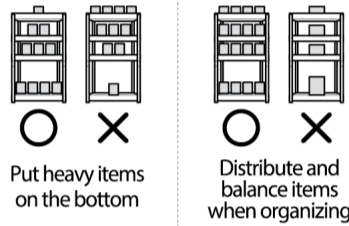

Put heavy items on the bottom

Distribute and balance items when organizing



It can be dangerous when using the very bottom space too high. Please keep and use the proper height.

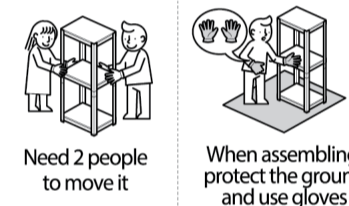

Need 2 people to move it

When assembling, protect the ground and use gloves

PSH-062326    A SG904018-5B    B SG703015-5B    C SG904518-5B    D SG904018-5W    E SG804018-5B    F SG703015-4B

# STEEL SHELVING UNIT

# HOMEDANT

## The Best Organizing Solution

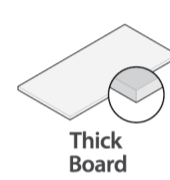
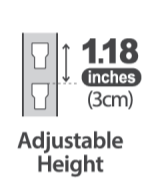
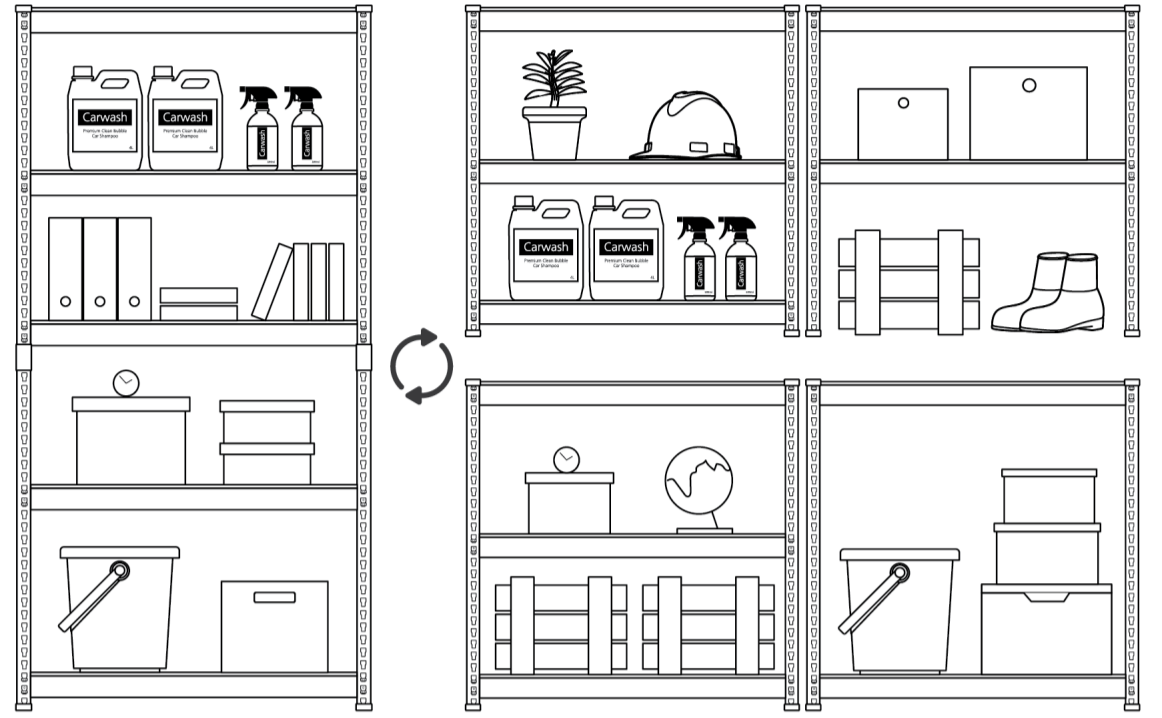

www.homedant.com

Contact Us global@homedant.com

## COMPONENTS

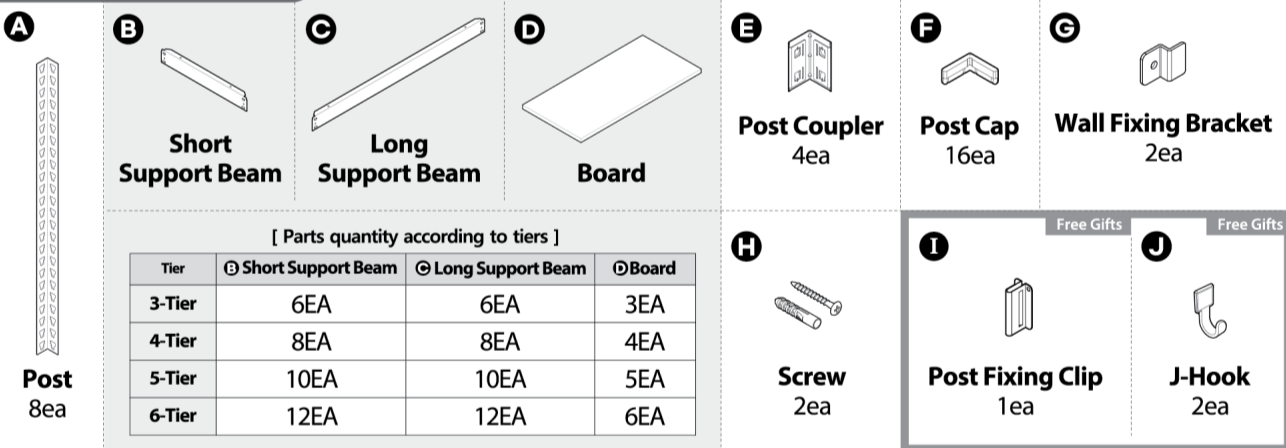

## PRE-ASSEMBLY TIPS

### Assembling the POST & COUPLER

#### Connecting direction

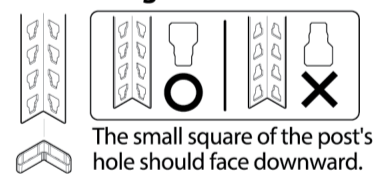

#### Connecting the Posts

Fix A post + E coupler + A other post sequentially and solidly.

\* Please check the direction of the post's hole.

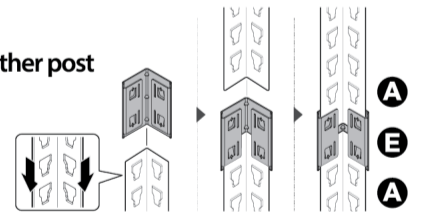

### Disassembling the POST & COUPLER

#### Disassembling the posts

- With one hand grab the bottom post and with other hand grab the upper post.
- Shake the upper post from side to side.

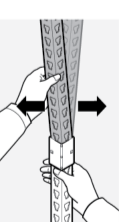

#### Disassembling the coupler

Using the Floor:

- Overlap a basic post on the post which is connected with the coupler.
- Grab them together and strike them into the floor to disassemble the coupler.

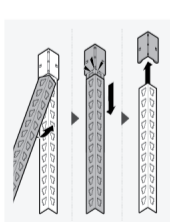

Using the rubber mallet:

- On the side where the post is connected with the coupler, put a other basic post slantly.
- Strike the basic post with a rubber mallet gently.

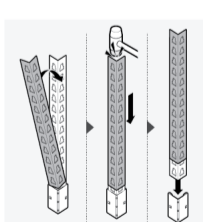

### Assembling the SUPPORT BEAM

Connecting the support beam: Put the protrusion parts of the support beam in the holes of the post, then fix it. (Use a rubber mallet if necessary.)

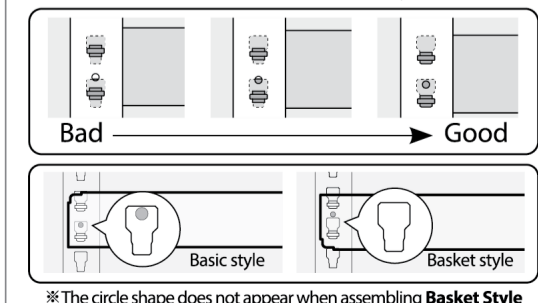

#### Various ways to assemble support beam:

You can assemble it in various ways depending on how you connect the support beam.

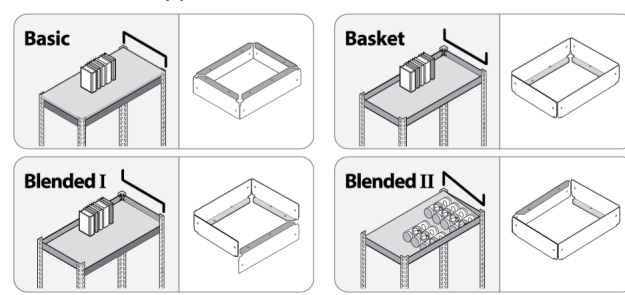

## ASSEMBLY INSTRUCTIONS (Based on 5-tier)

\* The way to assemble is all same regardless of tiers.



**BASIC ASSEMBLY VIDEO**  
You can assemble much easier if watch the video and instructions together.

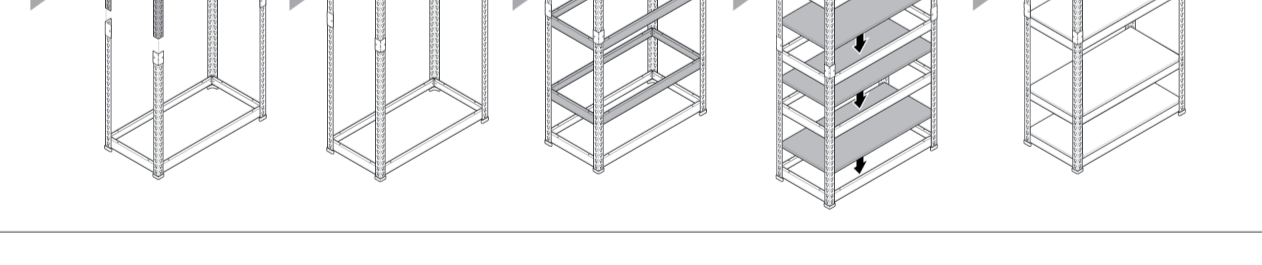
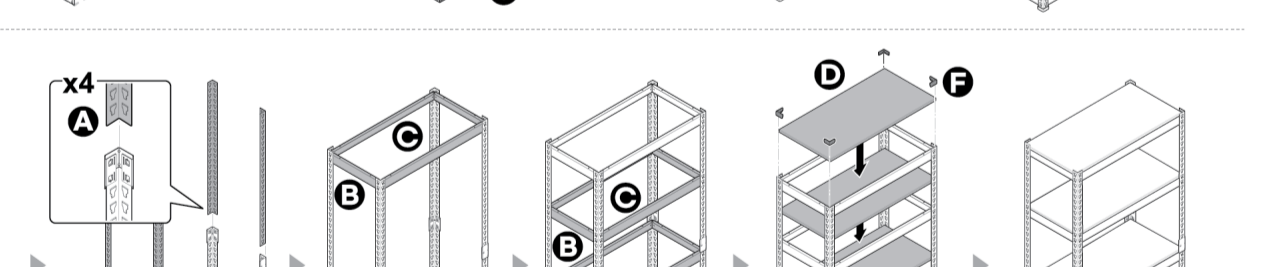
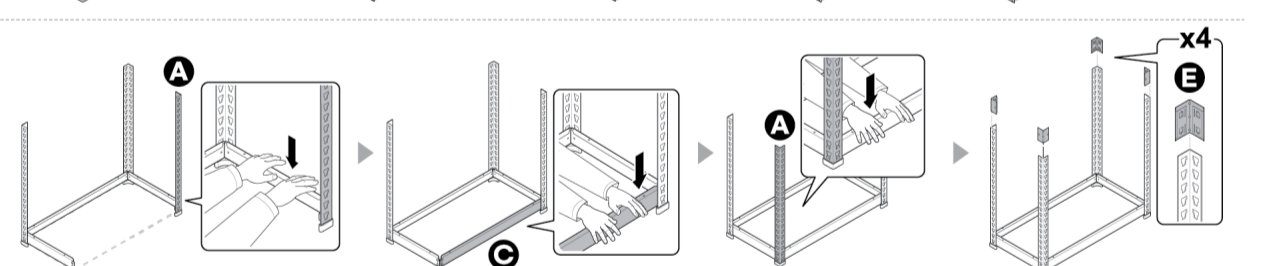
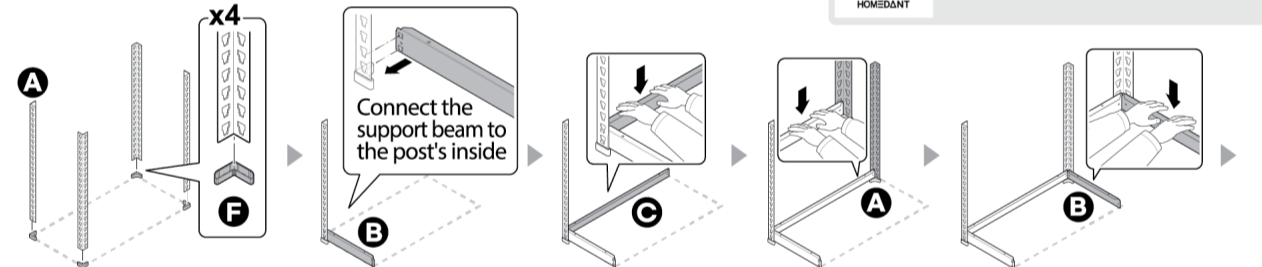

## ACCESSORIES

### Tip Post Fixing Clip (Special gift)

You can fix multiple modules tightly as a single module by connecting the clip to the shelving's post.

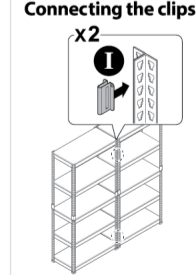

### Tip Disassembling the clip

Hold the edge of the clip with fingertips and pull out outside.

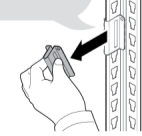

### Tip Assembling J-hook (Special gift)

Put J-hook in post hole then utilize it variously to organize more efficiently.

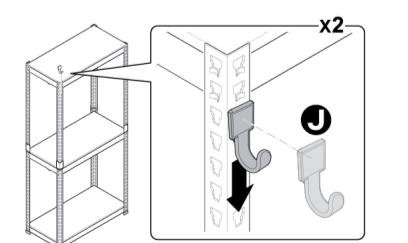

### Tip Wall Fixing Bracket

To prevent product from falling forward, mount it on the wall with wall fixing bracket.

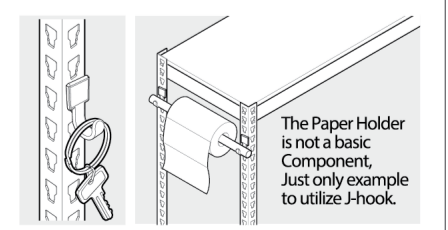
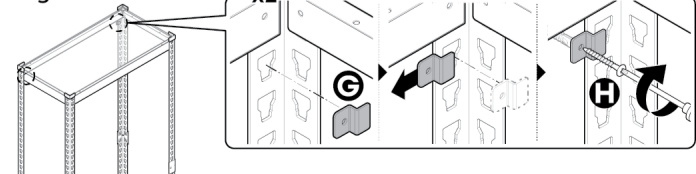

The Paper Holder is not a basic Component. Just only example to utilize J-hook.