

POWERFORCE[®] COMPACT

USER GUIDE
2112 SERIES



More of a video person? Look for this icon and go online for an instructional how-to video at

www.BISSELL.com/videos

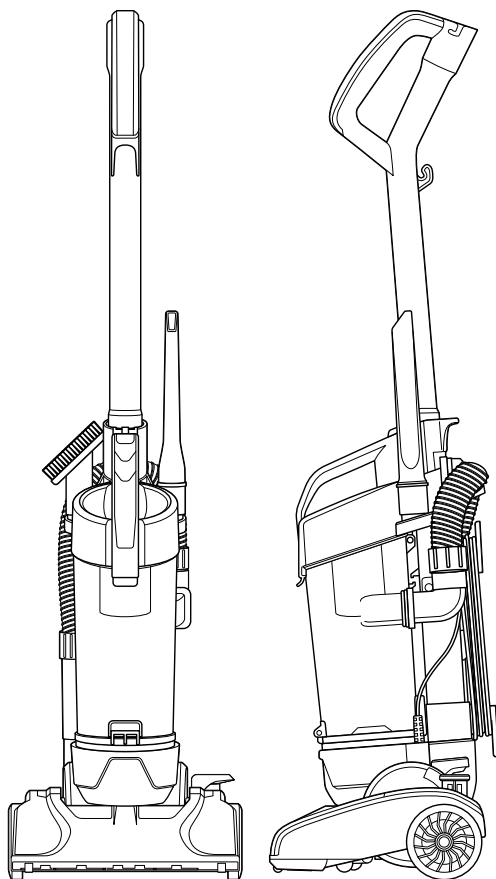

IMPORTANT SAFETY INSTRUCTIONS

READ ALL INSTRUCTIONS BEFORE USING YOUR UPRIGHT VACUUM.

Always connect to a polarized outlet (one slot is wider than the other). Unplug from outlet when not in use and before conducting maintenance. When using an electrical appliance, basic precautions should be observed, including the following:

WARNING

TO REDUCE THE RISK OF FIRE, ELECTRIC SHOCK, OR INJURY:

- » Always connect to a polarized outlet (one slot is wider than the other). Do not modify the polarized plug to fit a non-polarized outlet or extension cord.
- » Do not leave vacuum cleaner when it is plugged in. Unplug from outlet when not in use and before servicing.
- » Do not use outdoors or on wet surfaces.
- » Do not allow to be used as a toy. Close attention is necessary when used by or near children.
- » Do not use for any purpose other than described in this User's Guide. Use only manufacturer's recommended attachments.
- » Do not use with damaged cord or plug. If appliance is not working as it should, has been dropped, damaged, left outdoors, or dropped into water, have it repaired at an authorized service center.

- » Do not pull or carry by cord, use cord as a handle, close a door on cord, or pull cord around sharp edges or corners. Do not run appliance over cord. Keep cord away from heated surfaces.
- » Do not unplug by pulling on cord. To unplug, grasp the plug, not the cord.
- » Do not handle plug or vacuum cleaner with wet hands.
- » Do not put any object into openings. Do not use with any opening blocked; keep openings free of dust, lint, hair, and anything that may reduce air flow.
- » Keep hair, loose clothing, fingers, and all parts of body away from openings and moving parts.
- » Turn off all controls before plugging or unplugging vacuum cleaner.
- » Use extra care when cleaning on stairs.
- » Do not use to pick up flammable or combustible materials (lighter fluid, gasoline, kerosene, etc.) or use in areas where they may be present.
- » Do not use vacuum cleaner in an enclosed space filled with vapors given off by oil base paint, paint thinner, some moth proofing substances, flammable dust, or other explosive or toxic vapors.
- » Do not use to pick up toxic material (chlorine bleach, ammonia, drain cleaner, etc.).
- » Do not pick up anything that is burning or smoking, such as cigarettes, matches, or hot ashes.
- » Do not use without filters in place.
- » Do not pick up hard or sharp objects such as glass, nails, screws, coins, etc.
- » Use only on dry, indoor surfaces.
- » Keep appliance on a level surface.
- » Do not carry the vacuum cleaner while it is running.
- » Unplug before connecting or disconnecting the TurboBrush® Tool or TurboEraser® Pet Tool (on select models).

WARNING

- » Plastic film can be dangerous. To avoid danger of suffocation, keep away from children.
- » Do not plug in your vacuum cleaner UNTIL you are familiar with all instructions and operating procedures.
- » To reduce the risk of electrical shock, turn power switch off and disconnect polarized plug from electrical outlet BEFORE performing maintenance or troubleshooting checks.

THIS APPLIANCE HAS A POLARIZED PLUG

To reduce the risk of electric shock, this appliance has a polarized plug (one blade is wider than the other). This plug will fit in a polarized outlet only one way. If the plug does not fit fully in the outlet, reverse the plug. If it still does not fit, contact a qualified electrician to install a proper outlet. Do not change the plug in any way.

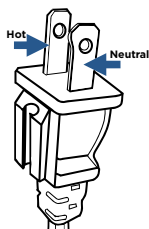

SAVE THESE INSTRUCTIONS

This model is for household use only.

Thanks for buying a BISSELL vacuum!

We love to clean and we're excited to share one of our innovative products with you. We want to make sure your vacuum works as well as it does today for years to come, so this guide has tips on using (page 11), maintaining (pages 14-17), and if there is a problem, troubleshooting (page 18).

In just a few simple assembly steps, you'll be ready to vacuum. Flip to page 5 and let's get started!

What's In The Box?

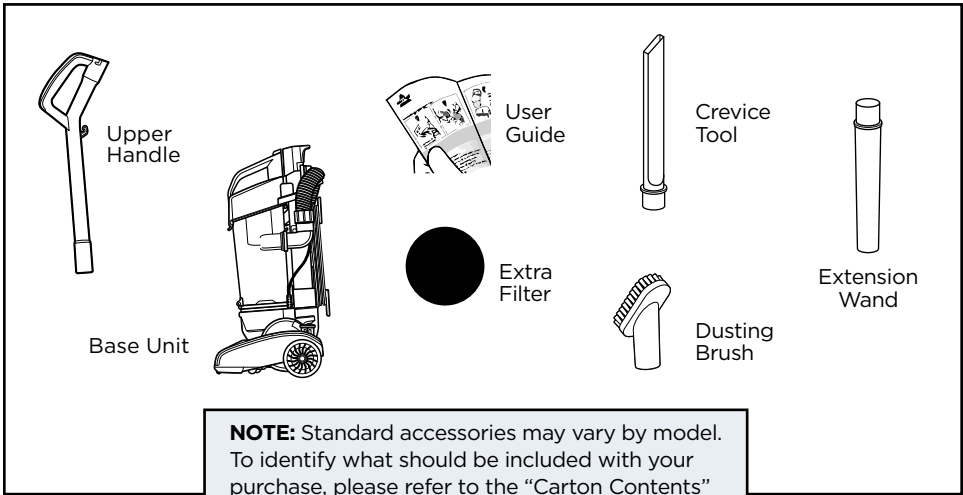

NOTE: Standard accessories may vary by model. To identify what should be included with your purchase, please refer to the "Carton Contents" list located on the carton top flap.

Safety Instructions.....	2	Troubleshooting	10
Product View.....	4	Warranty.....	11
Assembly	5	Service.....	11
Operations	6-7	Contact Information	11
Maintenance & Care	8-9	Product Registration.....	12

Product View

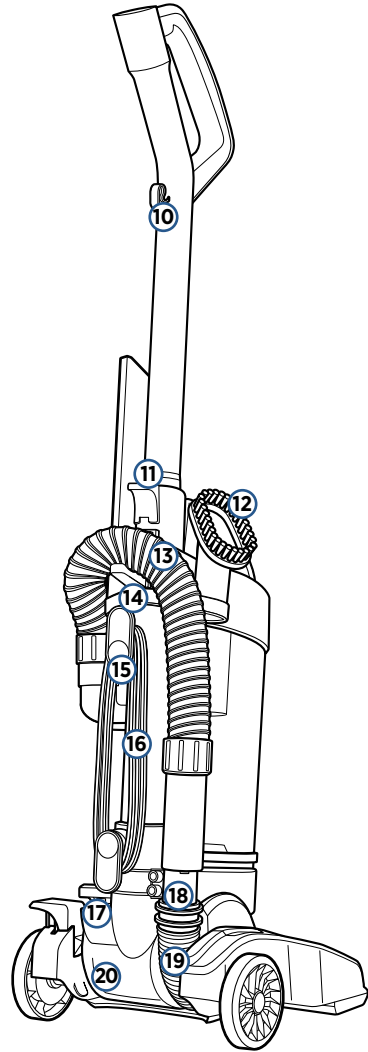
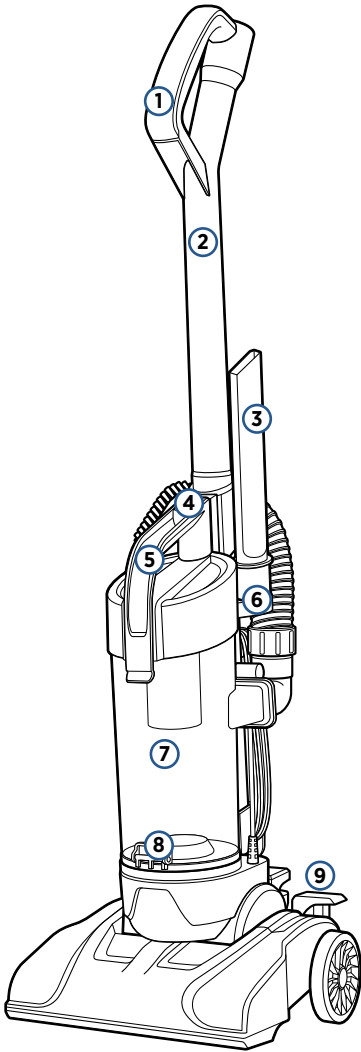

- 1 Handle
- 2 Handle/High Reach Extension Wand
- 3 Crevice Tool
- 4 Tank Release Button
- 5 Carrying Handle
- 6 Accessory Holder
- 7 Dirt Container
- 8 Dirt Container Empty Button
- 9 Handle Recline Pedal

- 11 Extension Wand Release
- 12 Dusting Brush
- 13 Stretch Hose
- 14 Hose Clip
- 15 Upper Quick Release™ Cord Wrap
- 16 Power Cord
- 17 Power Switch Pedal
- 18 Hose Holder
- 19 Foot Hose
- 20 Product Rating Label & Serial Number

Assembly



⚠️ WARNING

Do not plug in your vacuum until you are familiar with all instructions and operating procedures.

1

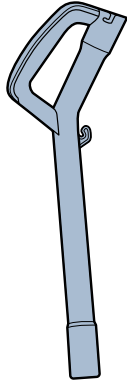

Position the handle so the lower tab is facing the back of the vacuum. Insert the handle into the base and push until you hear it lock into place.

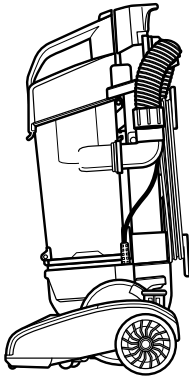

2

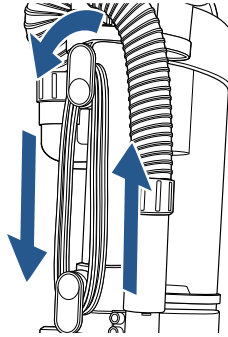

Wrap the power cord around Upper and Lower Cord Wraps.

3

Attach tools by inserting them onto the on-unit tool holders.

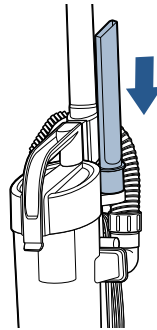

Crevice Tool

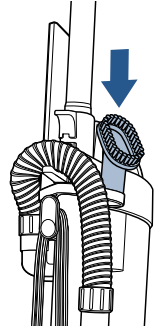

Dusting Brush

Using Your Cleaner

⚠️ WARNING

Before using your vacuum, make sure that the dirt container is in locked position and that all filters, both pre and post-filters are in place. **DO NOT** operate your vacuum without these filters.

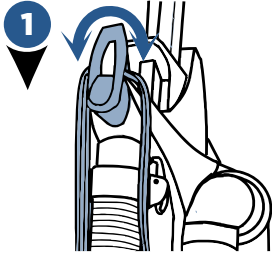

1 Twist the Upper Quick Release™ Cord Wrap down to quickly remove cord.

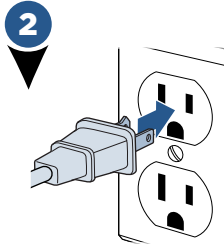

2 Connect power cord plug to a polarized outlet.

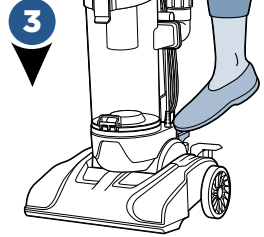

3 Step on the red power switch on the back to turn the unit ON.

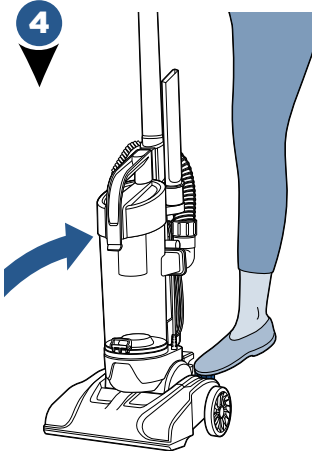

4 Press the handle recline pedal with your foot to place your vacuum in one of three positions:

Upright - For storage and transporting.

Normal Cleaning - Press handle release pedal once for most household floor cleaning tasks.

Low Cleaning - With the vacuum in normal cleaning position, press handle release pedal again for reaching under low furniture, such as tables, chairs, or beds.

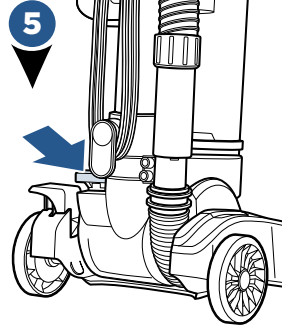

5 To turn the unit OFF, step again on the red power switch on the back of the unit, found under the cord wraps.

NOTE: Some berber carpets have a tendency to fuzz with wear. Repeated strokes in the same area may enhance this condition.

Above Floor Cleaning



1

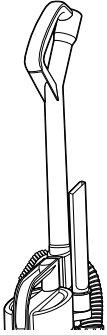

Raise handle to upright position.

2

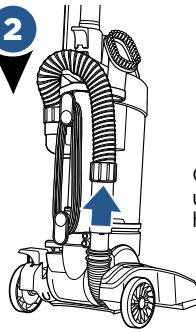

Grasp hose and pull up to remove from hose holder.

3

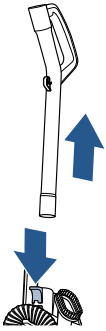

For extended reach, remove the extension wand by pressing the extension wand release lever and pulling the handle out of the body.

4

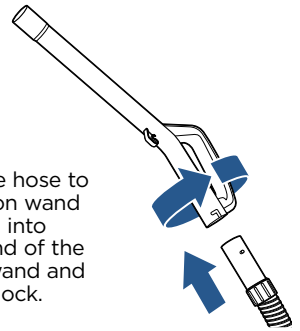

Connect the hose to the extension wand by inserting into the open end of the extension wand and twisting to lock.

5

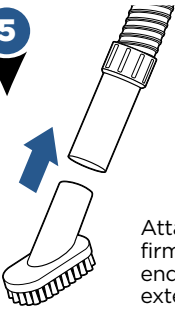

Attach desired tool by firmly pushing onto end of vacuum hose or extension wand.

6

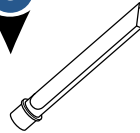

Crevice Tool

Use in tight and narrow spaces.



Dusting Brush

Use to dust upholstery, blinds, shelves, and more.

ATTENTION: The floor brush will continue to rotate while using your vacuum for above floor cleaning. To prevent carpet damage, do not lean on the vacuum or let the power foot tilt forward.

Power Cord Storage

WARNING

To reduce the risk of electric shock, turn power switch OFF and disconnect plug from electrical outlet before performing maintenance or troubleshooting checks.

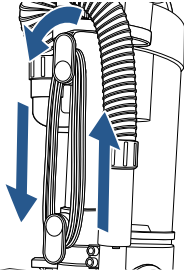

When you have finished using your vacuum, store the power cord on the cord wraps. Loop power cord around cord wraps on back of cleaner, making certain the Upper Quick Release cord wrap is pointed up towards the handle and the Lower Quick Release cord wrap is pointed down towards the floor. Clip molded plug to power cord to secure.

Emptying the Dirt Container

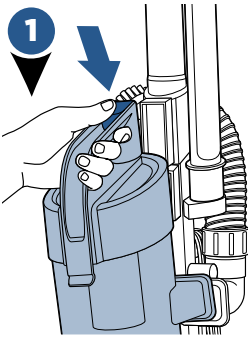

Remove Dirt Container by pushing the Dirt Container Release Button on top of the tank handle.

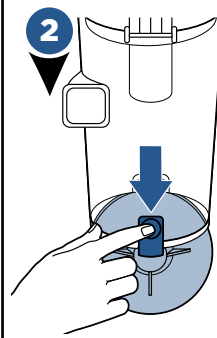

Holding Dirt Container over garbage bin, press Release Button on back. Snap bottom back into place and return to unit, pushing to lock into place.

NOTE: The dirt container may be washed in warm water with a mild detergent. Rinse and dry thoroughly before re-attaching it. This is not dishwasher safe.

Cleaning the Dirt Container

WARNING

To reduce the risk of electrical shock, turn power switch OFF and disconnect polarized plug from electrical outlet before performing maintenance or troubleshooting checks.

1

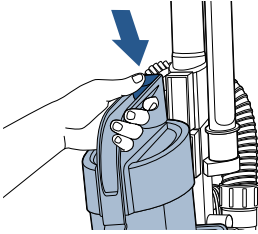

Remove Dirt Container by pushing the Dirt Container Release Button on top of the tank handle.

2

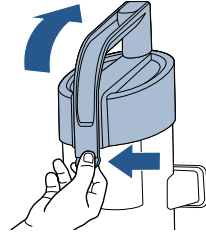

Open dirt container lid by lifting the release latch.

3

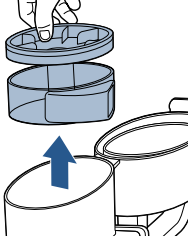

Remove primary separator by lifting out of the dirt container. Container and separator can be washed with hand-warm water. Mild detergent may be used. Rinse well then air dry completely.

4

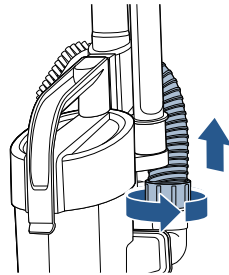

Remove hose by twisting to unlock and pull up. Check inlet for any clogging before reassembling.

Cleaning the Filter

⚠️ WARNING

To reduce the risk of electric shock, turn power switch OFF and disconnect plug from electrical outlet before performing maintenance or troubleshooting checks.

⚠️ WARNING

Do not operate vacuum with damp or wet filters, as well as without filters or the Dirt Container in place. Allow components to dry before reassembling the Dirt Container.

1

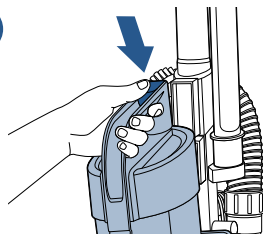

Remove Dirt Container by pushing the Dirt Container Release Button on top of the tank handle.

2

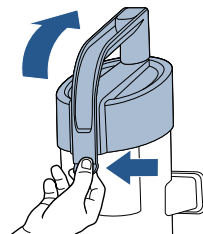

The filter is located inside of the dirt container lid. Open dirt container lid by lifting the release latch.

3

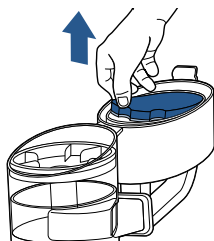

Grasp the filter and pull to remove. The filter can be washed by hand-warm water. Mild detergent may be used. Rinse well, then air dry completely before returning to dirt container lid.

4

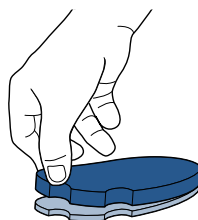

Place the filter back in the dirt container lid. The white mesh side should be put in first with the black foam side still visible. Align the locating details on the filter with the locating features in the tank lid.

NOTE: If the filter is still excessively dirty, damaged or torn, it will need to be replaced.

Cleaning the Brush Roll

⚠️ WARNING

To reduce the risk of electric shock, turn power switch OFF and disconnect plug from electrical outlet before performing maintenance or troubleshooting checks.

1

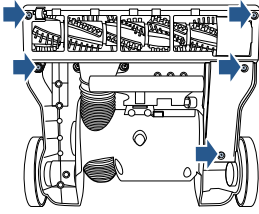

Place vacuum upside down with brush roll facing upwards. Remove 5 screws with a Phillips screwdriver.

2

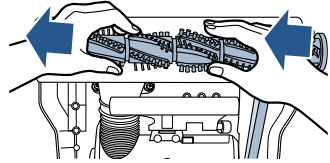

Lift off brush cover and grasp floor brush at both ends to lift out. Clean debris from brush roll, motor pulley, and drive belt. If brush roll is worn, replace as needed.

3

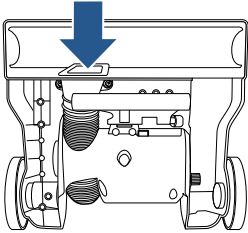

Check air passageway for obstructions.

4

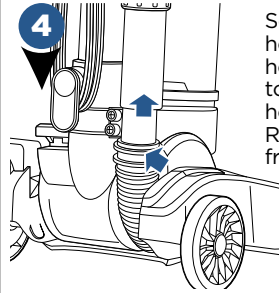

Separate the hose from the hose wand base to look through hose for clogs. Remove debris from this area.

5

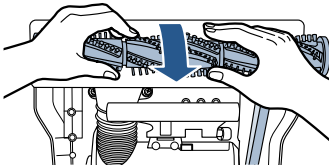

When finished cleaning, align brush roll with belt turning by hand several times in the direction of the motor to align the belt on the floor brush.

6

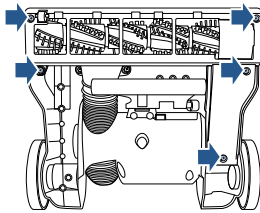

Replace the brush cover and 5 screws.

NOTE: If an object becomes lodged in foot and brush shuts off, turn vacuum off and unplug from electrical outlet. Remove obstruction and brush will automatically reset when vacuum is plugged and turned back on.

Replacing Drive Belt

⚠ WARNING

To reduce the risk of electric shock, turn power switch OFF and disconnect plug from electrical outlet before performing maintenance or troubleshooting checks.

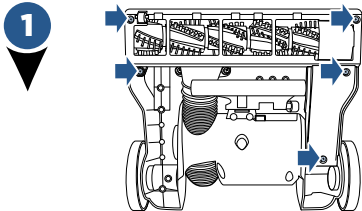

Place vacuum upside down with brush roll facing upwards. Remove 5 screws with a Phillips screwdriver.

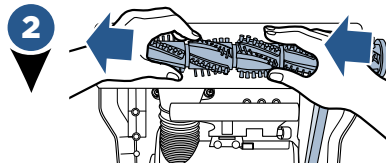

Lift off brush cover and grasp floor brush at both ends to lift out. Check drive belt carefully for wear, cuts and stressed areas. If the drive belt appears worn, replace as needed.

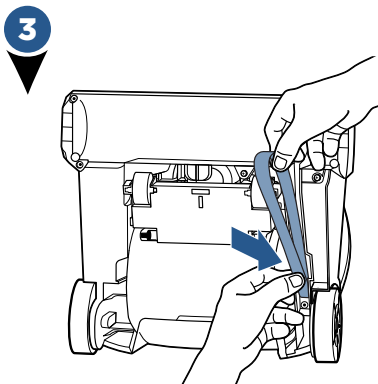

Grasp old drive belt and remove from motor shaft to discard. Loop new drive belt over motor shaft and stretch other end over floor brush in the space provided between the bristles.

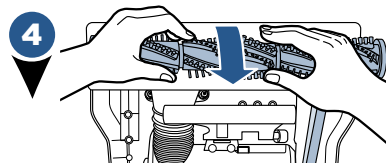

When finished, align brush roll with belt turning by hand several times in the direction of the motor to align the belt on the floor brush.

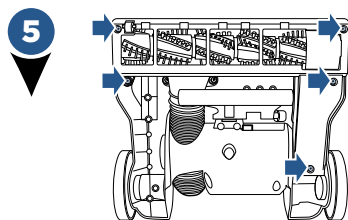

Replace the brush cover and 5 screws.

Cleaning the Hose and Foot

⚠️ WARNING

To reduce the risk of electric shock, turn power switch OFF and disconnect plug from electrical outlet before performing maintenance or troubleshooting checks.

1

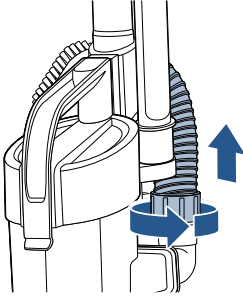

Locate the stretch hose where it connects to the hose elbow on the back of the vacuum. Look to see if there is any debris in the hose and hose elbow. Clean as necessary.

2

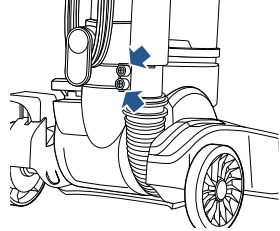

Locate the clear foot hose under the hose holder. Remove the two screws and clear clogs and debris in the hose. Use a long narrow object such as a broomstick to clean the hose. Replace two screws and re-attach stretch hose by sliding over inlet and rotating upwards towards the lock position.

NOTE: If the debris cannot be reached through the hose, then follow the instructions for cleaning the air passageway in “Cleaning the Brush Roll” section.

Parts & Supplies

For Parts and Supplies, go to www.BISSELL.com and enter your model number in the search field.

Troubleshooting

WARNING

To reduce the risk of electric shock, turn power switch OFF and disconnect plug from electrical outlet before performing maintenance or troubleshooting checks.

Problem	Possible causes	Remedies
Vacuum cleaner won't run	Power cord not plugged in	Check electrical plug
	Blown fuse/tripped breaker	Check/replace fuse or reset breaker
Vacuum cleaner won't pick up dirt	Dirt container is full	Empty dirt container
	Filter dirty	Check, remove debris or clean
	Hose not secure	Check to be sure hose is snapped into place at both ends
	Dirt container not in place	Make sure dirt container is completely inserted and snapped into place.
	Vacuum path clogged	Visually check air passageway, hose inlet, and hose for anything that might be obstructing the vacuum path. Carefully remove blockage.
	Rotating power brush drive belt broken	Replace drive belt
	Drive belt stretched	Check drive belt area and remove obstructions. Replace drive belt if necessary
	Floor brush bristles worn	Replace floor brush
	Floor brush jammed	Remove floor brush and clean debris from brush and ends. Check drive belt for any damage.

Please do not return this product to the store.

Other maintenance or service not included in the manual should be performed by an authorized service representative.

Thank you for selecting a BISSELL product.

For any questions or concerns, BISSELL is happy to be of service. Contact us directly at 1-800-237-7691.

Warranty

This warranty gives you specific legal rights, and you may also have other rights which may vary from state to state. If you need additional instruction regarding this warranty or have questions regarding what it may cover, please contact BISSELL Consumer Care by E-mail, telephone, or regular mail as described below.

Limited One-Year Warranty

Subject to the *EXCEPTIONS AND EXCLUSIONS identified below, upon receipt of the product BISSELL will repair or replace (with new or remanufactured components or products), at BISSELL's option, free of charge from the date of purchase by the original purchaser, for one year any defective or malfunctioning part.

See information below on "If your BISSELL product should require service".

This warranty applies to product used for personal, and not commercial or rental service. This warranty does not apply to fans or routine maintenance components such as filters, belts, or brushes. Damage or malfunction caused by negligence, abuse, neglect, unauthorized repair, or any other use not in accordance with the User's Guide is not covered.

BISSELL IS NOT LIABLE FOR INCIDENTAL OR CONSEQUENTIAL DAMAGES OF ANY NATURE ASSOCIATED WITH THE USE OF THIS PRODUCT. BISSELL'S LIABILITY WILL NOT EXCEED THE PURCHASE PRICE OF THE PRODUCT.

Some states do not allow the exclusion or limitation of incidental or consequential damages, so the above limitation or exclusion may not apply to you.

*EXCEPTIONS AND EXCLUSIONS FROM THE TERMS OF THE LIMITED WARRANTY

THIS WARRANTY IS EXCLUSIVE AND IN LIEU OF ANY OTHER WARRANTIES EITHER ORAL OR WRITTEN. ANY IMPLIED WARRANTIES WHICH MAY ARISE BY OPERATION OF LAW, INCLUDING THE IMPLIED WARRANTIES OF MERCHANTABILITY AND FITNESS FOR A PARTICULAR PURPOSE, ARE LIMITED TO THE ONE YEAR DURATION FROM THE DATE OF PURCHASE AS DESCRIBED ABOVE.

Some states do not allow limitations on how long an implied warranty lasts so the above limitation may not apply to you.

NOTE: Please keep your original sales receipt. It provides proof of date of purchase in the event of a warranty claim.

Service

If your BISSELL product should require service:

Contact BISSELL Consumer Care to locate a BISSELL Authorized Service Center in your area.

If you need information about repairs or replacement parts, or if you have questions about your warranty, contact BISSELL Consumer Care.

Website:

www.BISSELL.com

E-mail:

www.BISSELL.com/email-us

Call:

BISSELL Consumer Care

1-800-237-7691

Monday - Friday 8am - 10pm ET

Saturday 9am - 8pm ET

Sunday 10am - 7pm ET

Please do not return this product to the store.

Other maintenance or service not included in the manual should be performed by an authorized service representative.

For any questions or concerns, BISSELL is happy to be of service. Contact us directly at 1-800-237-7691.

Register your product today!

Registering is quick, easy and offers you benefits over the lifetime of your product.

You'll receive:

BISSELL Rewards Points

Automatically earn points for discounts and free shipping on future purchases.

Faster Service

Supplying your information now saves you time should you need to contact us with questions regarding your product.

Product Support Reminders and Alerts

We'll contact you with any important product maintenance reminders and alerts.

Special Promotions

Optional: Register your email to receive notice of offers, contests, cleaning tips and more!

Visit www.BISSELL.com/registration!

Visit the BISSELL website: www.BISSELL.com

When contacting BISSELL, have model number of cleaner available.

Please record your Model Number: _____

Please record your Purchase Date: _____

NOTE: Please keep your original sales receipt. It provides proof of purchase date in the event of a warranty claim. See Warranty on page 11 for details.

Parts & Supplies

For Parts and Supplies, go to www.BISSELL.com and enter your model number in the search field.

We can't wait to hear from you!

Rate this product and let us (and millions of your closest friends) know what you think!

www.BISSELL.com



©2017 BISSELL Homecare, Inc.
Grand Rapids, Michigan
All rights reserved. Printed in China
Part Number 160-1355 03/17
Visit our website at: www.BISSELL.com